



EASY LOCK INFORMATION

At Just Autos, our Easy Lock aims to enhance your vehicle's transmission performance and reliability. By locking the torque converter, we can reduce transmission temperatures and eliminate the constant shifting that disrupts smooth power delivery. To preserve the factory drivability, our system automatically locks the converter at speeds above 45 km/h which follows factory transmission strategy. GDJ79 will still maintain Haul functionality and will hold a lower gear to improve performance while towing

> When will lock up engage

- Lock up will engine from 1500RPM from 2nd to 6th gear.

> How do I switch on my Easy Lock?

Easy Lock is switched on by depressing the ECO (Hilux), PWR/Haul Button (GDJ70) or Rotating dial to ECO (Hilux 48v). Enabling sports/manual shift will also engage Easy lock.

> How do I know Easy Lock up is on?

Once the ECO or PWR/Haul switch is pressed the light will illuminate on the dash letting you know Easy Lock function is engaged

> Will PWR & ECO Button still work as it did previously?

PWR Button will still retain previous function.

> How should I drive when using Easy Lock?

When using Easy Lock Just Autos recommends using Sport Shift to govern correct gear choice while towing.

> How does this benefit my vehicle?

Lock up operation can aid in the reduction of of transmission temperatures, improve fuel economy and help with general drivability of the vehicle.

GDJ79

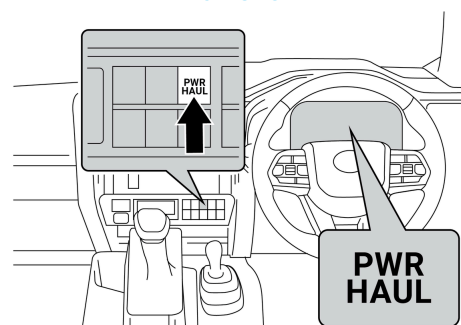

Hilux

Hilux - 48v

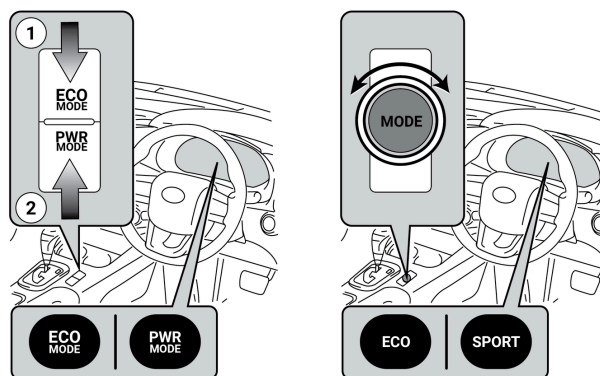

** Lock up speeds may vary depending on tyre sizes & diff ratios **

Just Autos

DIESEL PERFORMANCE & DYNO TUNING SPECIALISTS

(07) 5476 0066 www.justdieselpower.com.au

Nambour, Sunshine Coast - 11 Windsor Rd, Nambour QLD 4560

UP TO
50% DROP
IN TRANS TEMPS