



FOLLOW OUR SOCIALS

# EASY LOCK INFORMATION

At Just Autos, our Easy Lock aims to enhance your vehicle's transmission performance and reliability. By locking the torque converter, we can reduce transmission temperatures and eliminate the constant shifting that disrupts smooth power delivery. To preserve the factory drivability, our system automatically locks the converter at speeds above 45 km/h which follows factory transmission strategy. GDJ79 will still maintain Haul functionality and will hold a lower gear to improve performance while towing

## > Lock up speed / Unlock speed

- Lock Up speed - 45km/h
- Unlock Speed - 40km/h

## > How do I switch on my Easy Lock?

Easy Lock is switched on by depressing the PWR (Hilux), PWR/Haul Button (GDJ70) or Rotating dial to Sports (Hilux 48v)

## > How do I know Easy Lock up is on?

Easy Lock once engaged will illuminate the PWR, PWR/Haul or Sports light on the dash "Gearbox strategy has been altered to suit towing".

## > Will PWR & ECO Button still work as it did previously?

These buttons will not retain their original function, recommend remap/multimap to achieve desired throttle response.

## > How should I drive when using Easy Lock?

When using Easy Lock Just Autos recommends using Sport shift to govern correct gear choice while towing

## > How does this benefit my vehicle?

Lock up operation can aid in the reduction of transmission temperatures, improve fuel economy and help with general drivability of the vehicle

GDJ79

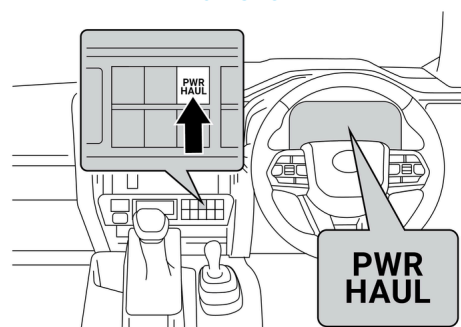

Hilux

Hilux - 48v

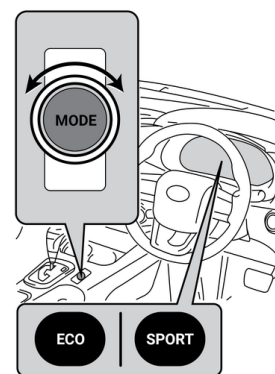
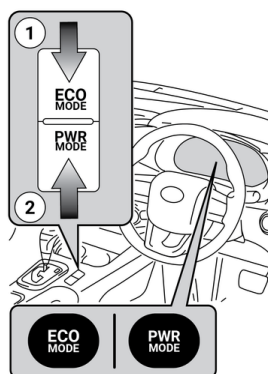

\*\* Lock up speeds may vary depending on tyre sizes & diff ratios \*\*